

3+

Barbie

INSTRUCTION

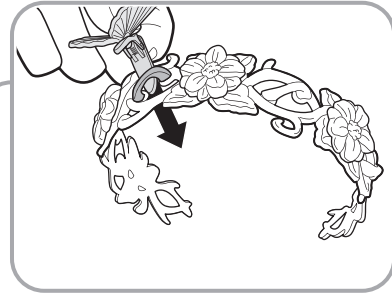

Attach barrettes!



Style Hair! Wear and Share!

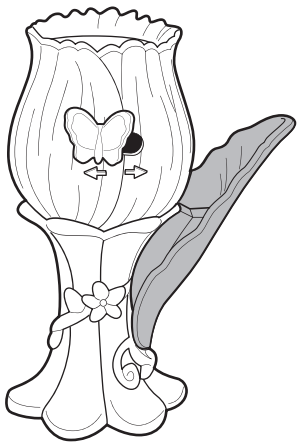
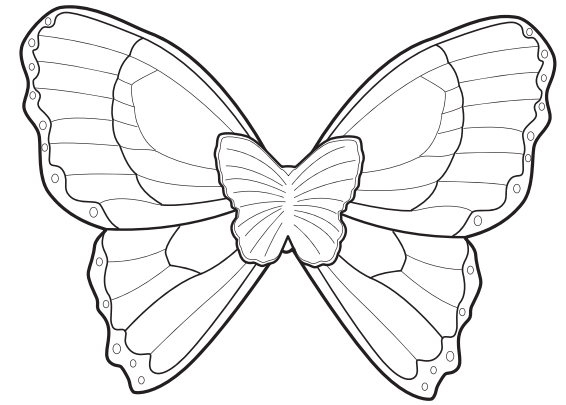
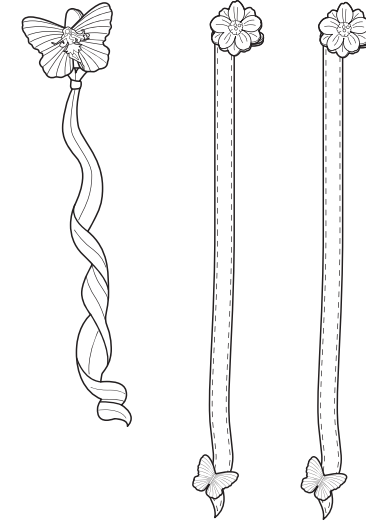
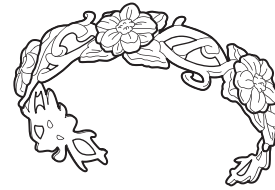
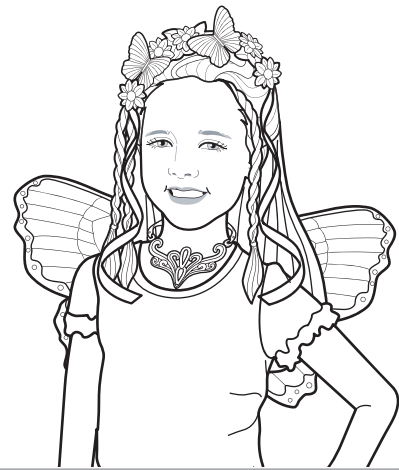
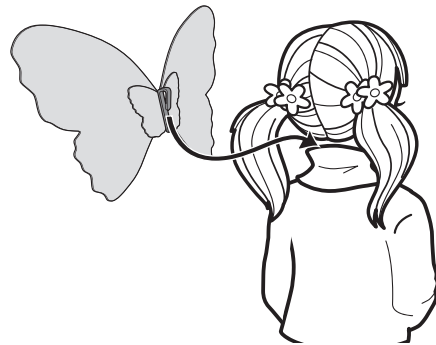
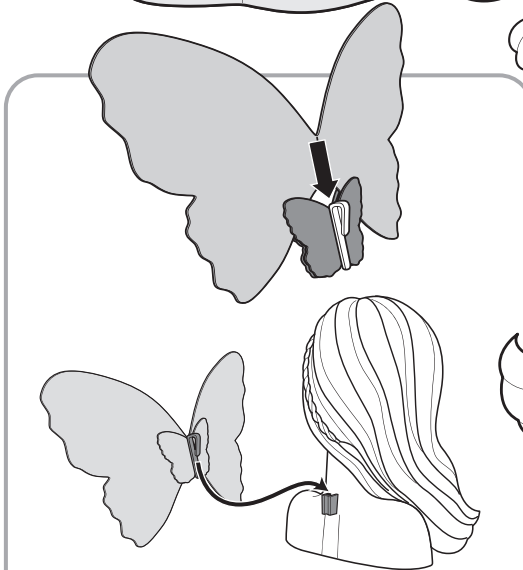

Pull ends of strips to release hair.
Remove any remaining thread
from doll's hair, then comb hair.



We listen to you!

We want you to have fun playing with our products.
Please give us your feedback by filling out the short on-line survey. Go to:
secure.mattel.com/surveys
Thanks for helping us make great toys even better!

CONSUMER INFORMATION

Need Assistance? Visit service.mattel.com or call 1-800-524-8697
(US and Canada only), M-F 9AM - 7PM & SAT 11AM - 5PM, Eastern.

SERVICE.MATTEL.COM

Mattel Canada Inc., Mississauga, Ontario L5R 3W2. You may call us free at/ Composez sans frais le 1-800-524-8697.
Mattel U.K. Ltd., Vanwall Business Park, Maidenhead SL6 4UB, Helpline 01628 500303.
Mattel Australia Pty., Ltd., Richmond, Victoria. 3121. Consumer Advisory Service - 1300 135 312.
Mattel East Asia Ltd., Room 1106, South Tower, World Finance Centre, Harbour City, Tsimshatsui, HK, China.
Diimport & Diedarkan Oleh: Mattel SEA Ptd Ltd.(993532-P) Lot 13.5, 13th Floor, Menara Lien Hoe, Persiaran Tropicana Golf Country
Resort, 47410 PJ. Tel: 03-78803817, Fax: 03-78803867.
Mattel, Inc., 333 Continental Blvd., El Segundo, CA 90245 U.S.A. Consumer Relations 1 (800) 524-8697.

Contents: Please remove everything from the package and compare to the contents shown here.
If any items are missing, please contact your local Mattel office. Keep these instructions for future
reference as they contain important information.

WARNING:
CHOKING HAZARD - Small parts.
Not for children under 3 years.



Water toys sometimes get messy. Protect play surfaces before use. Do not use on surfaces that can be damaged by water. Drain, rinse, clean, and dry all items thoroughly before storing.

PLAY TIME! Colour change by applying warm or cold water.

To colour change: Dip applicator in icy cold water. Cup not included. Glide applicator to reveal doll's eye shadow, lip color and cheek decoration.

To colour change back: Dip applicator in warm water and apply to doll to colour change back. DO NOT use water that is too hot (above 43°C/ 110°F) to avoid burns. Colour change will last longer if you do not expose this toy to intense heat or direct sunlight for prolonged periods of time.

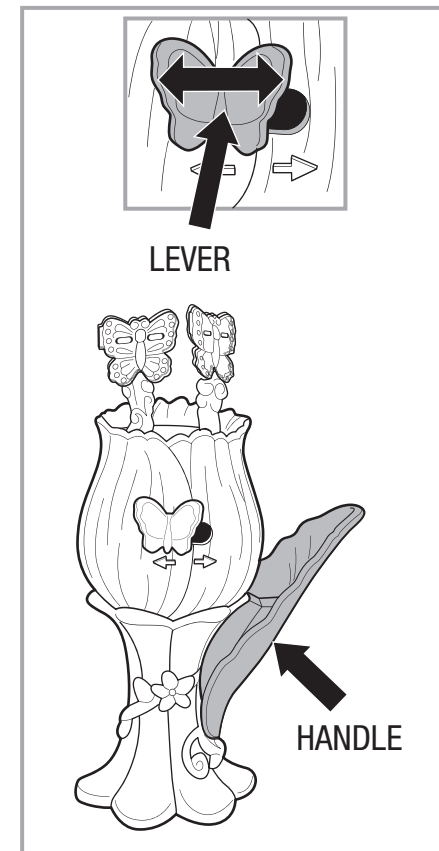

Twist!

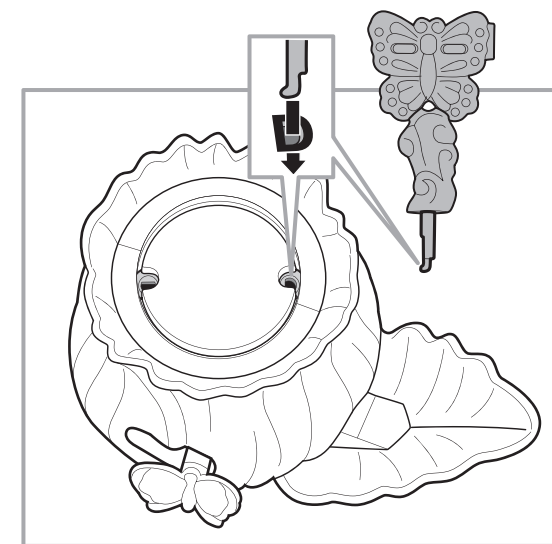
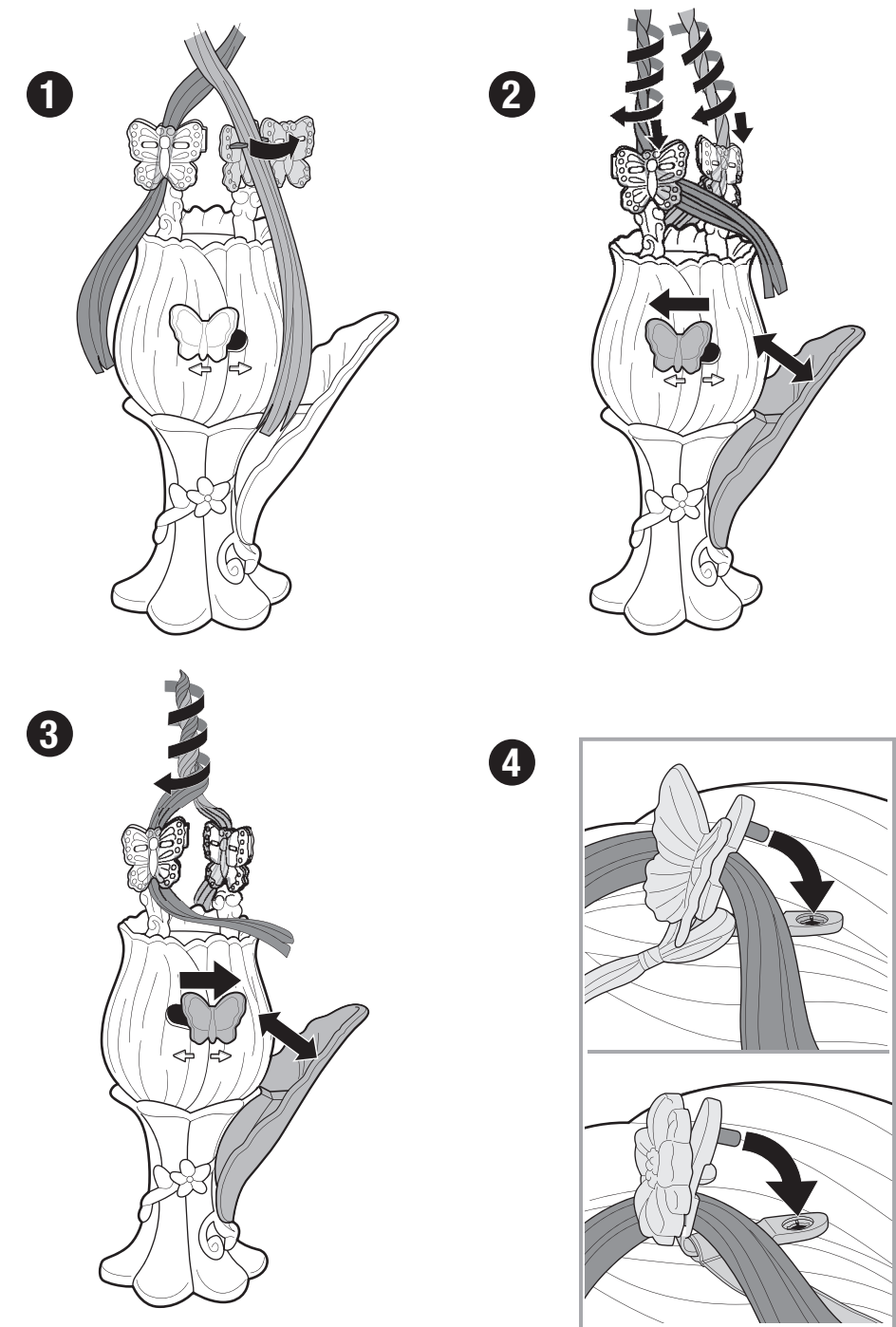

Use Twister/Braider to make double twisted braids in the doll's hair. Twister/Braider can also be used to twist braids into child's hair!

1. Insert strands of hair then snap shut.
2. Slide lever LEFT: Pull Twister/Braider away from doll's head to stretch hair strands apart, then press handle to twist them. Continue pressing. For best results, do not over twist hair.
3. Slide lever RIGHT: Then press handle to twist hair strands together.
4. Fasten with barrette.